



*Board of Commissioners*  
Doug Barnes, *Chair*  
John Welch  
TerryLynn Stewart  
Regina Elmi  
Richard Jackson  
  
*President/CEO*  
Robin Walls

## INVITATION TO BID

Manufactured Home Dealer for Purchase, Delivery & Installation  
at  
Rainier View Mobile Home Park 32631 1st Ave, Black Diamond, WA 98010

October 18, 2024

### ADDENDUM NO. 1

This addendum is used to clarify, change, delete, add to or substitute items in the original contract documents.

BID DATE: ~~October 21, 2024 at 3:00 pm~~ Monday, November 4, 2024 at 3:00 pm

QUESTIONS DEADLINE: Friday, October 25, 2024

NUMBER OF PAGES: 16

ATTACHMENTS: 15 PAGES

CONTRACT NUMBER: Rainier View MHP

NOTICE TO BIDDERS: Bidders are hereby notified of the following changes and/or clarifications to the Contract Documents for this project.

CHANGES:

1. Bid Due date is now November 4, 2024 at 3:00 pm
2. Building Site Plans added

All other provisions of the Contract Documents remain unchanged.

### END OF ADDENDUM NO. 1

RAINIER VIEW MANUFACTURED HOME PARK

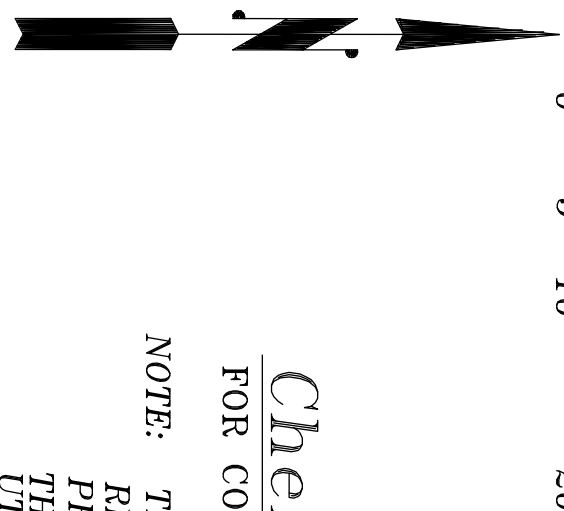

INTERSECTION OF 1ST AND BAKER ST.  
MOUNTAIN IN CASE

ELEV.: 650.43

All references to property lines,

# Chehalis Valley Surveying

**NOTE: THE CONTRACTOR SHALL BE FULLY**

PROTECTION OF ALL EXISTING UTILITIES. THE CONTRACTOR SHALL VERIFY ALL UTILITY LOCATIONS PRIOR TO CONSTRUCTION BY CALLING THE UNDERGROUND LOCATE LINE AT 1-800-424-5555 A MINIMUM OF 48 HOURS PRIOR TO ANY EXCAVATION.

APPROVED FOR CONSTRUCTION

Signed, City Engineer

Approval Expires: \_\_\_\_\_

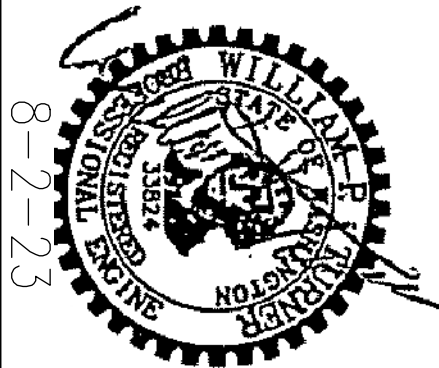

Rainier View  
Manufactured Home Park

## Street Site Plan

**Turner  
Consulting  
Engineer**  
4405 7th Ave SE Suite 301  
Lacey, WA 98503  
360-491-6900

REVISION BLOCK:

DESIGN INFORMATION		
PROJECT IDENTIFICATION No.		
FILE NAME:	BW-COVER SITE PLAN	
ACTION		
DESIGNED		8/2/23
DRAWN		8/2/23
CHECKED		8/2/23
PLOTTED DATES		

SHEET ID CODE

ST 1 of 2

SHEET No.

1 of 2

RAINIER VIEW MANUFACTURED HOME PARK

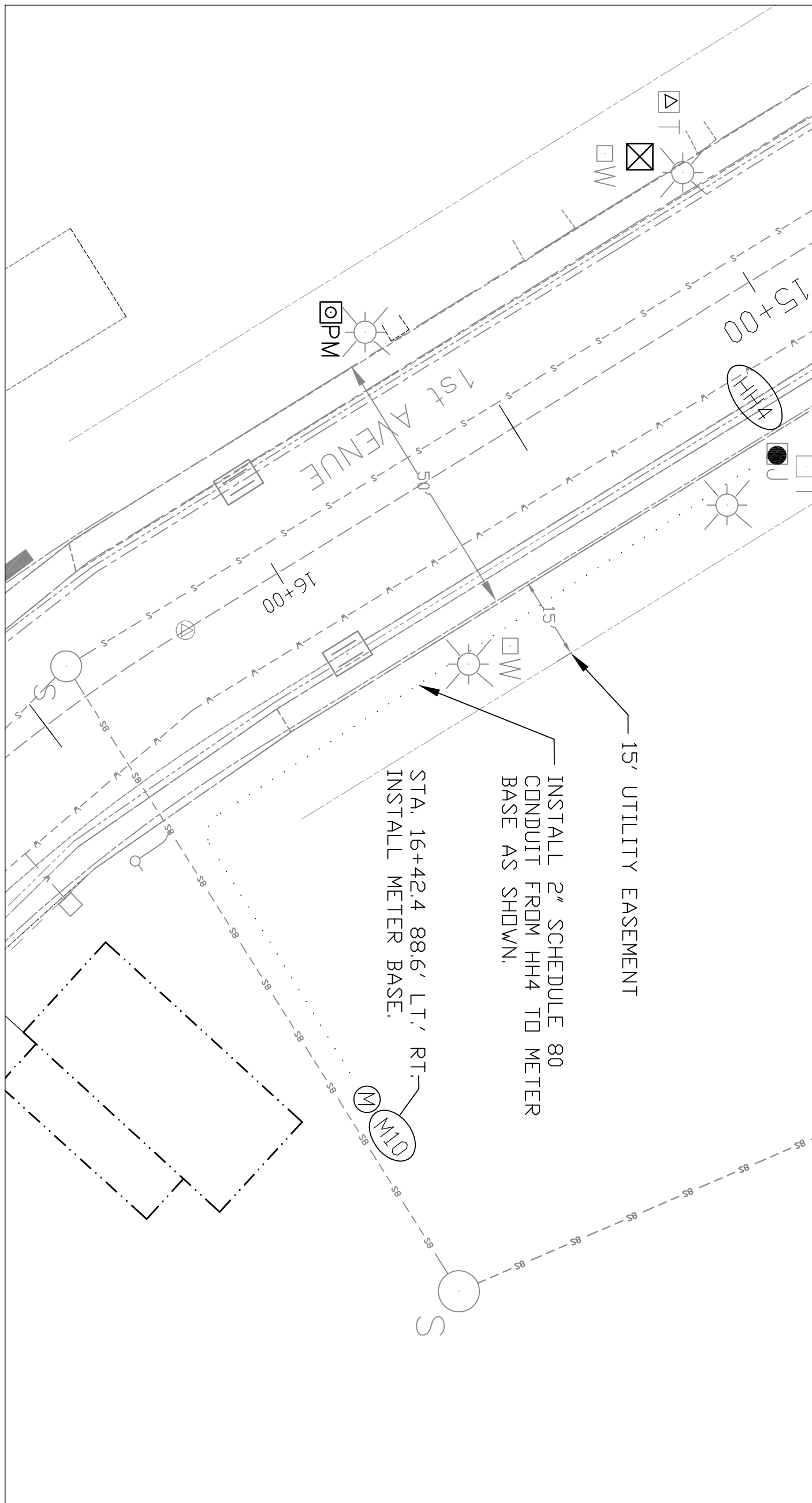

*Specification for Meter Pedestal:*

INSTALL 2" SCHEDULE 80  
CONDUIT FROM HH4 TO METER  
BASE AS SHOWN.

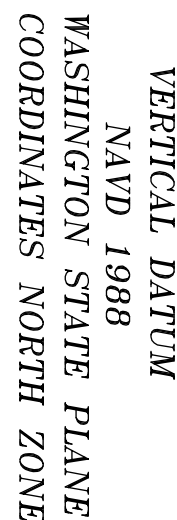
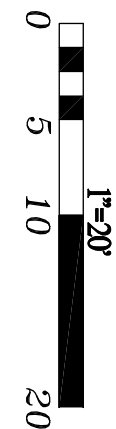

MONUMENT IN CASE  
NORTHING: 114872.14  
EASTING: 1349492.01  
BIRN: 850 48

# NOT A BOUNDARY SURVEY

All references to property lines, bearing, corners, or any references which indicate property alignment or locations were acquired from

FOR CONSTRUCTION USE ONLY

**NOTE:** THE CONTRACTOR SHALL BE FULLY RESPONSIBLE FOR THE LOCATION & PROTECTION OF ALL EXISTING UTILITIES. THE CONTRACTOR SHALL VERIFY ALL UTILITY LOCATIONS PRIOR TO CONSTRUCTION BY CALLING THE UNDERGROUND LOCATE LINE AT 1-800-424-5555 A MINIMUM OF 48 HOURS PRIOR TO ANY EXCAVATION.

BY: \_\_\_\_\_ DATE: \_\_\_\_\_

Approval Expires: \_\_\_\_\_

REVISION BLOCK:

Sec. 14, TWN. 21N, Range 6E, W.M.  
Rainier View  
Manufactured Home Park  
Street Site Plan

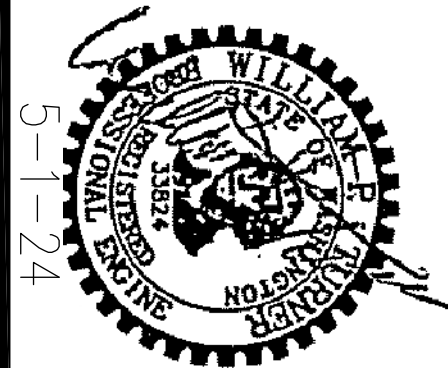

5-1-24

SHEET ID CODE  
EL 2 of 2

SHEET No.  
2 of 15



SEC. 14, TWN. 21N, Range 6E, W.M.

32624 FIRST AVE.

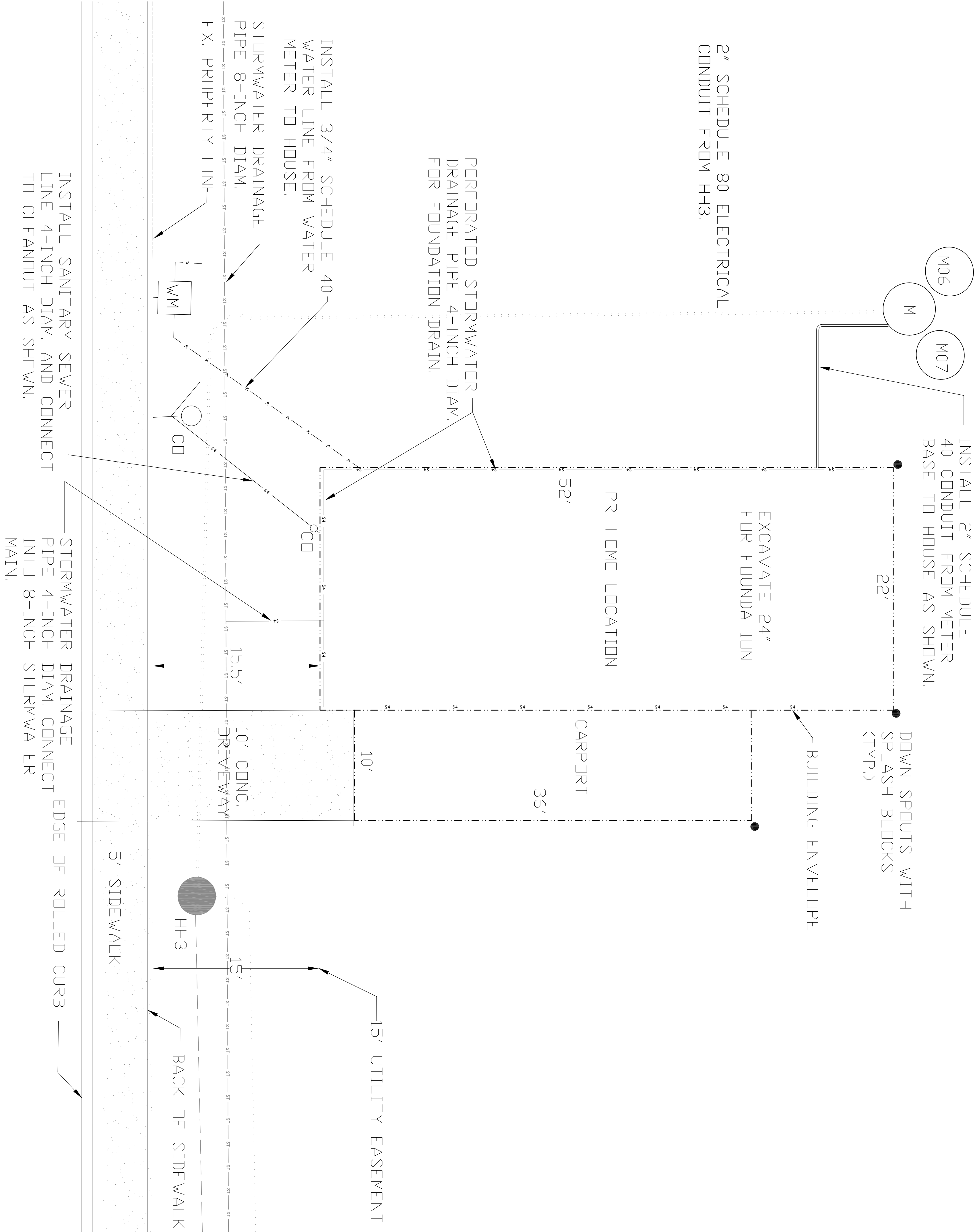

APPROVED FOR CONSTRUCTION

BY: \_\_\_\_\_ SIGNED: City Engineer DATE: \_\_\_\_\_

Approval Expires: \_\_\_\_\_

Sec. 14, TWN. 21N, Range 6E, W.M.

Rainier View  
Manufactured Home Park  
Building Site

Turner Consulting Engineer  
4405 7th Ave SE Suite 301  
Lacey, WA. 98503  
360-491-6900

REVISION BLOCK:

DESIGN INFORMATION		
PROJECT IDENTIFICATION No.		
FILE NAME: BW-COVER SITE PLAN		
ACTION		
DESIGNED		5-1-24
DRAWN		5-1-24
CHECKED		5-1-24
PLOTTED DATES		

SHEET ID CODE  
BS 2 of 13

SHEET No.  
4 of 15



SEC. 14, TWN. 21N, Range 6E, W.M.

32626 FIRST AVE.

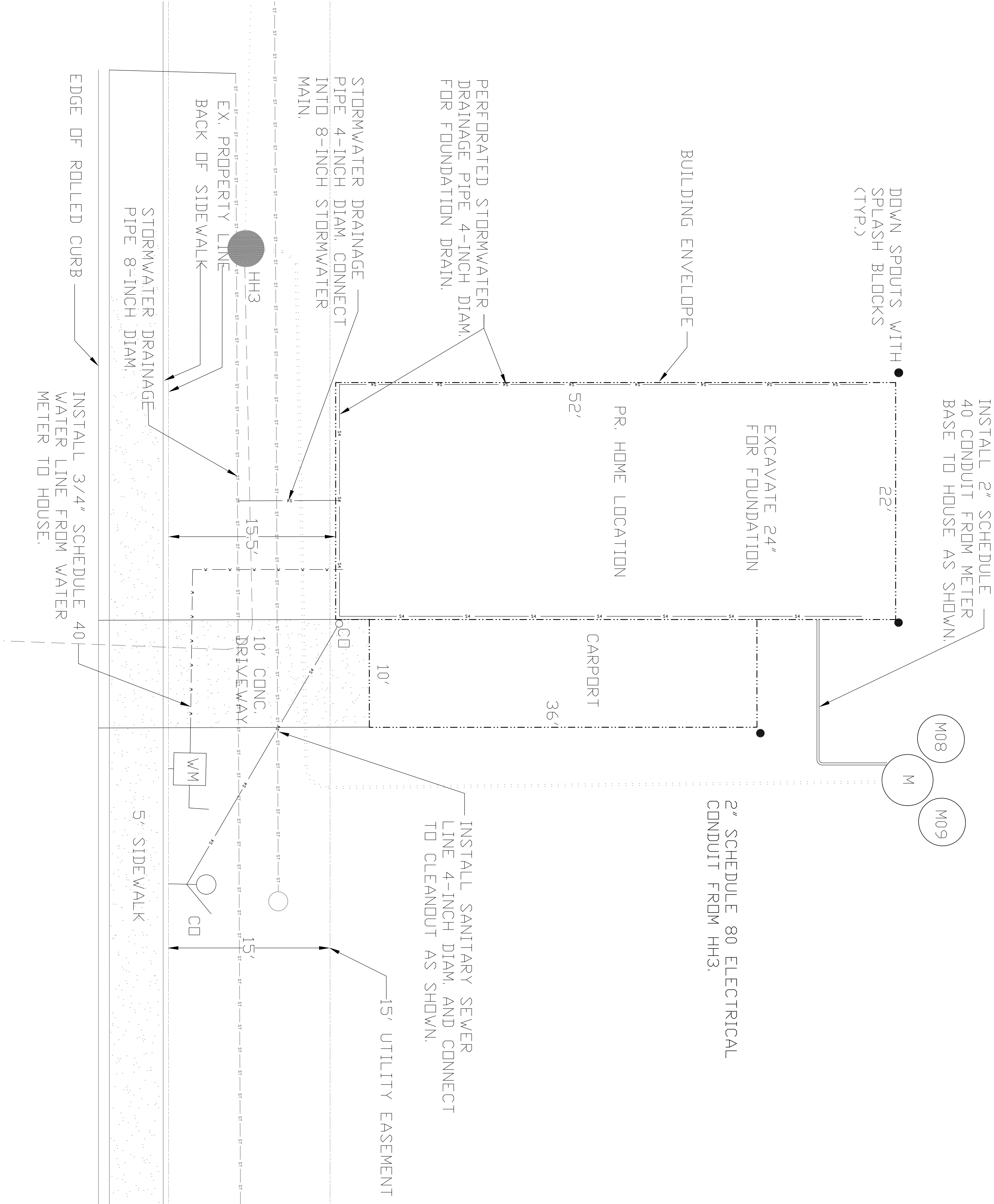

APPROVED FOR CONSTRUCTION

BY: \_\_\_\_\_ DATE: \_\_\_\_\_

Signed, City Engineer

Approval Expires: \_\_\_\_\_

Sec. 14, TWN. 21N, Range 6E, W.M.

Rainier View  
Manufactured Home Park  
Building Site

Turner Consulting Engineer  
4405 7th Ave SE Suite 301  
Lacey, WA. 98503  
360-491-6900

REVISION BLOCK:

DESIGN INFORMATION		
PROJECT IDENTIFICATION No.		
FILE NAME: BW-COVER SITE PLAN		
ACTION		
DESIGNED		5-1-24
DRAWN		5-1-24
CHECKED		5-1-24
PLOTTED DATES		

SHEET ID CODE

BS 3 of 13

SHEET No.

5 of 15

SEC. 14, TWN. 21N, Range 6E, W.M.

32628 FIRST AVE.

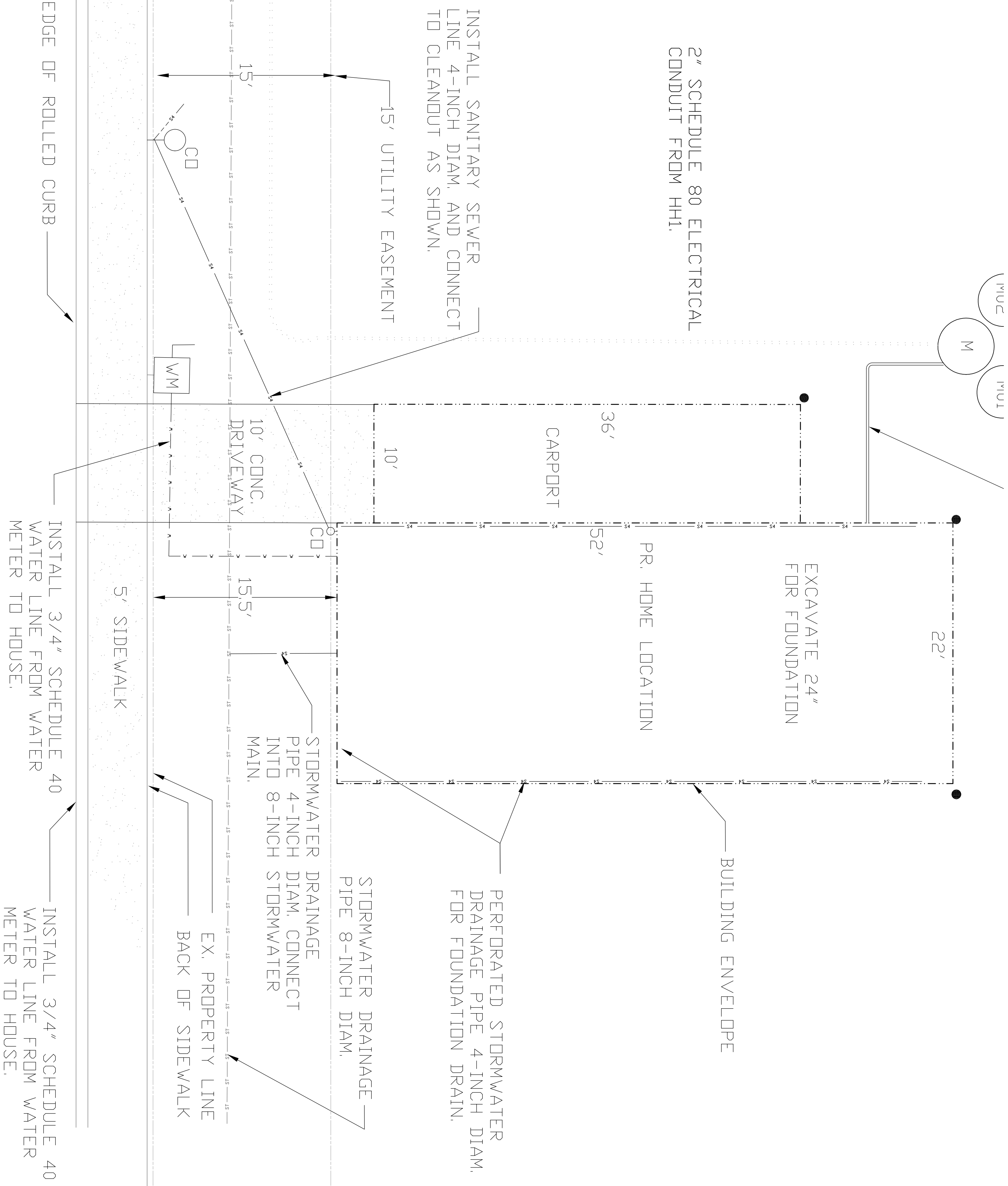

APPROVED FOR CONSTRUCTION

BY: \_\_\_\_\_ DATE: \_\_\_\_\_

Signed, City Engineer

Approval Expires: \_\_\_\_\_

Sec. 14, TWN. 21N, Range 6E, W.M.

Rainier View  
Manufactured Home Park  
Building Site

Turner Consulting Engineer  
4405 7th Ave SE Suite 301  
Lacey, WA 98503  
360-491-6900

REVISION BLOCK:

DESIGN INFORMATION		
PROJECT IDENTIFICATION No.		
FILE NAME: BW-COVER SITE PLAN		
ACTION		
DESIGNED		5-1-24
DRAWN		5-1-24
CHECKED		5-1-24
PLOTTED DATES		

SHEET ID CODE

BS 4 of 13

SHEET No.

6 of 15

SEC. 14, TWN. 21N, Range 6E, W.M.

32708 FIRST AVE.

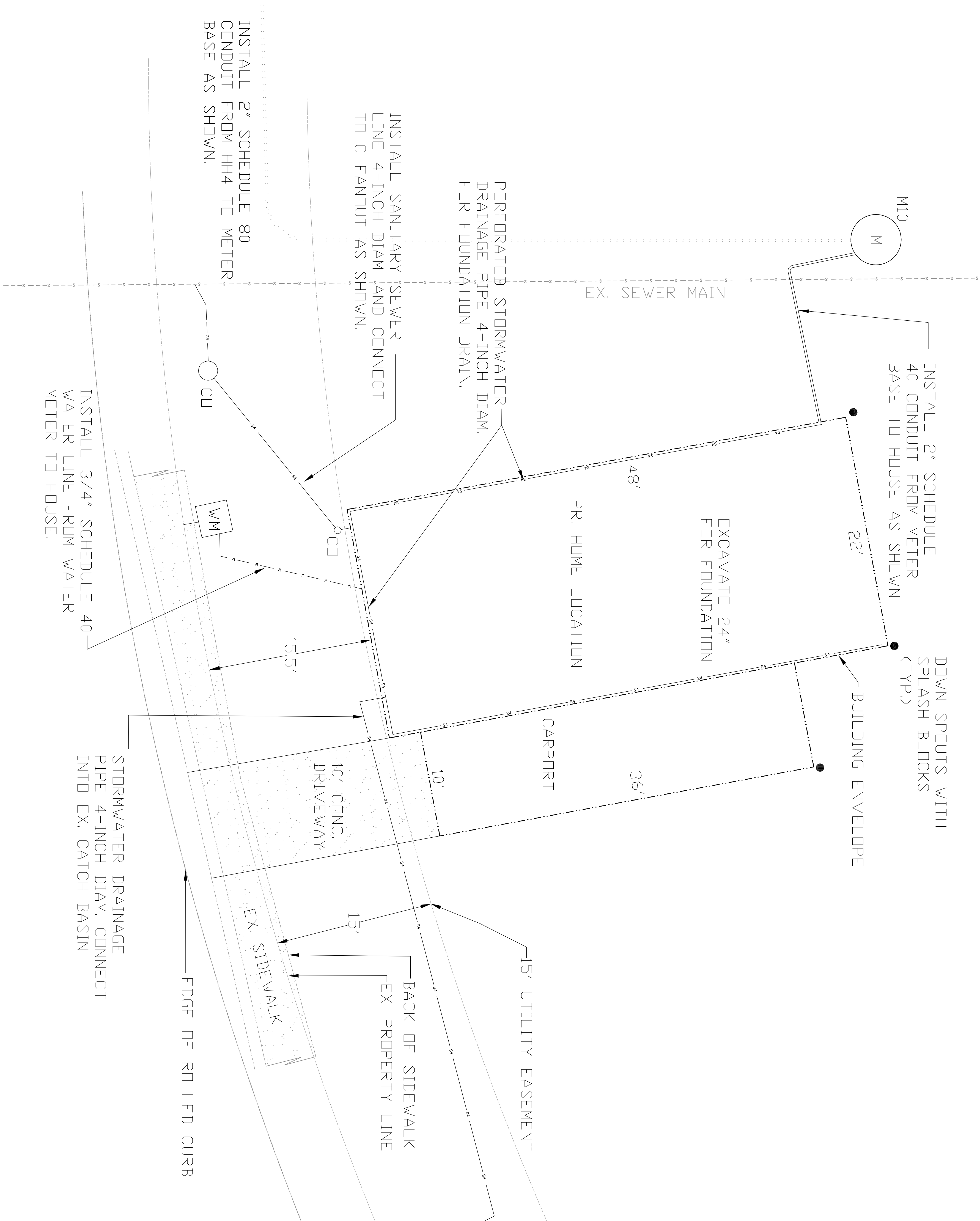

APPROVED FOR CONSTRUCTION

BY: \_\_\_\_\_ DATE: \_\_\_\_\_

Signed, City Engineer

Approval Expires: \_\_\_\_\_

Sec. 14, TWN. 21N, Range 6E, W.M.

Rainier View  
Manufactured Home Park  
Building Site

Turner Consulting Engineer  
4405 7th Ave SE Suite 301  
Lacey, WA. 98503  
360-491-6900

REVISION BLOCK:

DESIGN INFORMATION		
PROJECT IDENTIFICATION No.		
FILE NAME: BW-COVER SITE PLAN		
ACTION		
DESIGNED		5-1-24
DRAWN		5-1-24
CHECKED		5-1-24
PLOTTED DATES		

SHEET ID CODE  
BS 5 of 13

SHEET No.  
7 of 15



SEC. 14, TWN. 21N, Range 6E, W.M.

32621 FIRST AVE.

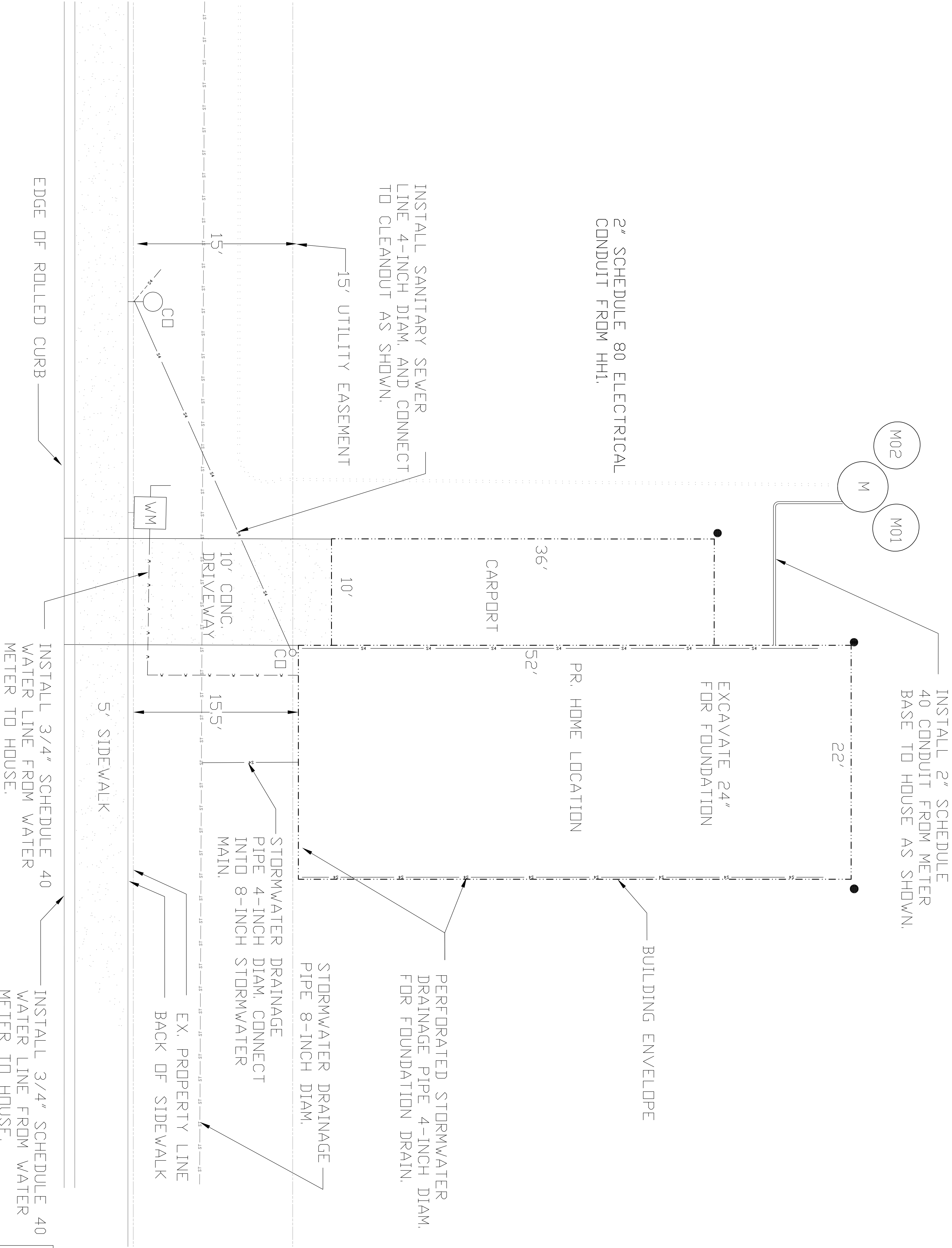

APPROVED FOR CONSTRUCTION

BY: \_\_\_\_\_ SIGNED, City Engineer DATE: \_\_\_\_\_

Approval Expires: \_\_\_\_\_

Sec. 14, TWN. 21N, Range 6E, W.M.

Rainier View  
Manufactured Home Park  
Building Site

Turner Consulting Engineer

4405 7th Ave SE Suite 301  
Lacey, WA. 98503  
360-491-6900

REVISION BLOCK:

DESIGN INFORMATION		
PROJECT IDENTIFICATION No.		
FILE NAME: BW-COVER SITE PLAN		
ACTION		
DESIGNED		5-1-24
DRAWN		5-1-24
CHECKED		5-1-24
PLOTTED DATES		

SHEET ID CODE  
BS 6 of 13

SHEET No.  
8 of 15



SEC. 14, TWN. 21N, Range 6E, W.M.

32625 FIRST AVE.

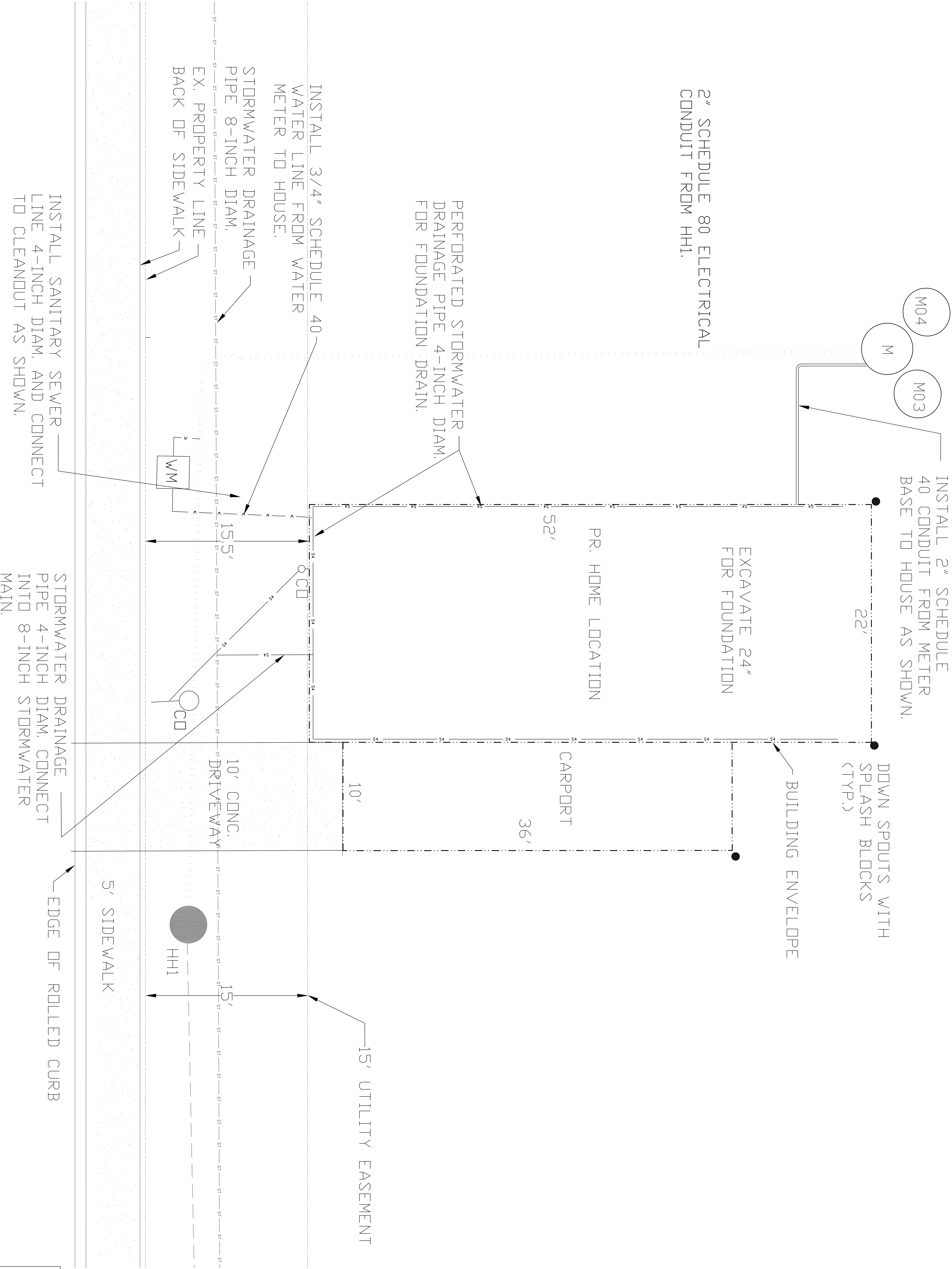

APPROVED FOR CONSTRUCTION

BY: \_\_\_\_\_ SIGNED, City Engineer DATE: \_\_\_\_\_

Approval Expires: \_\_\_\_\_

Sec. 14, TWN. 21N, Range 6E, W.M.

Rainier View  
Manufactured Home Park  
Building Site

Turner Consulting Engineer  
4405 7th Ave SE Suite 301  
Lacey, WA. 98503  
360-491-6900

REVISION BLOCK:

DESIGN INFORMATION		
PROJECT IDENTIFICATION No.		
FILE NAME: BW-COVER SITE PLAN		
ACTION		
DESIGNED		5-1-24
DRAWN		5-1-24
CHECKED		5-1-24
PLOTTED DATES		

SHEET ID CODE  
BS 8 of 13

SHEET No.  
10 of 15





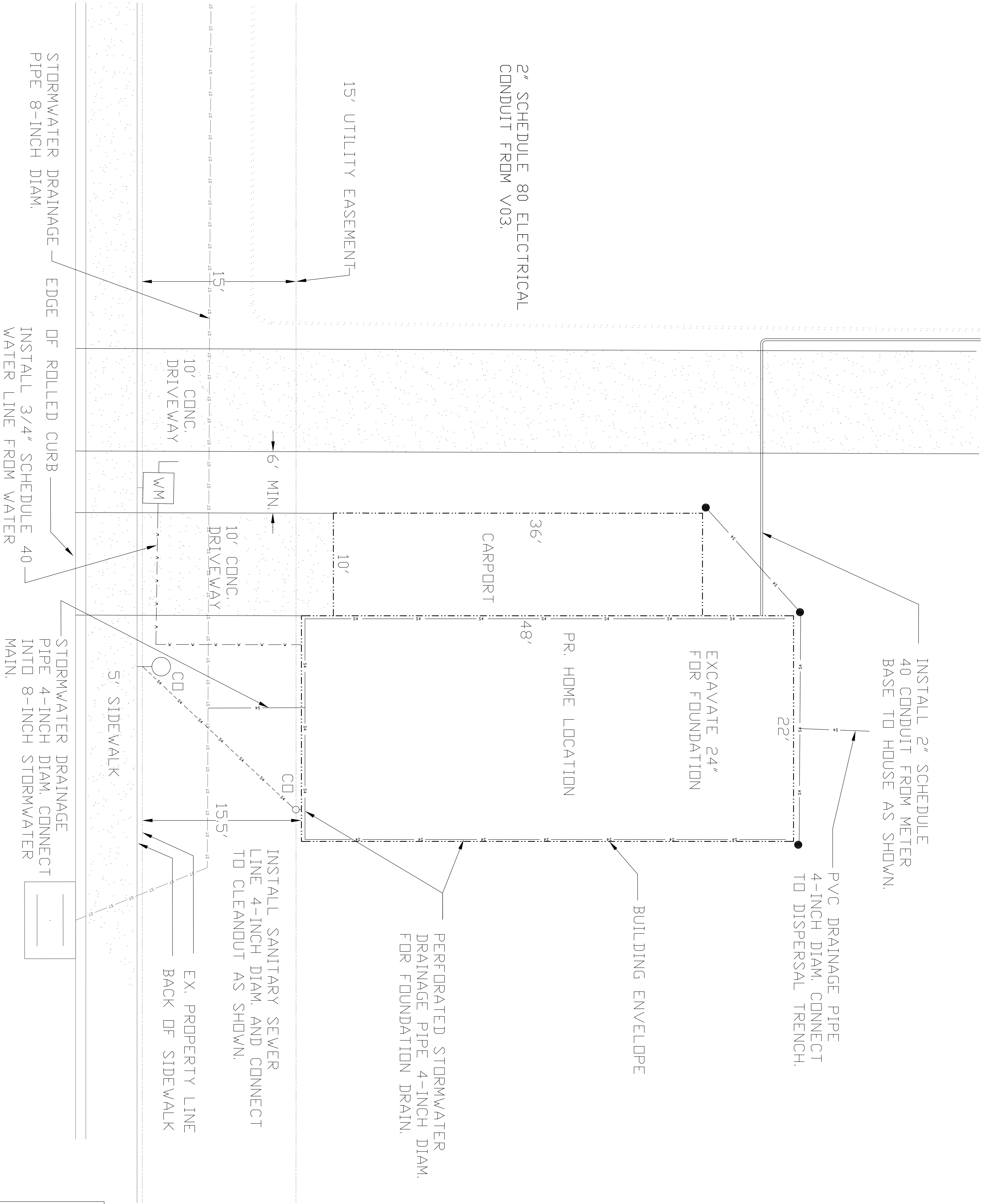

APPROVED FOR CONSTRUCTION

BY: \_\_\_\_\_ DATE: \_\_\_\_\_  
Signed, City Engineer  
Approval Expires: \_\_\_\_\_

Sec. 14, TWN. 21N, Range 6E, W.M.

Rainier View

Manufactured Home Park

Building Site

**Turner** Consulting Engineer

4405 7th Ave SE Suite 301  
Lacey, WA 98503  
360-491-6900

REVISION BLOCK:

DESIGN INFORMATION		
PROJECT IDENTIFICATION No.		
FILE NAME: BW-COVER SITE PLAN		
ACTION		
DESIGNED		5-1-24
DRAWN		5-1-24
CHECKED		5-1-24
PLOTTED DATES		

SHEET ID CODE  
BS 11 of 13

SHEET No.  
13 of 15



SEC. 14, TWN. 21N, Range 6E, W.M.

LOT 1

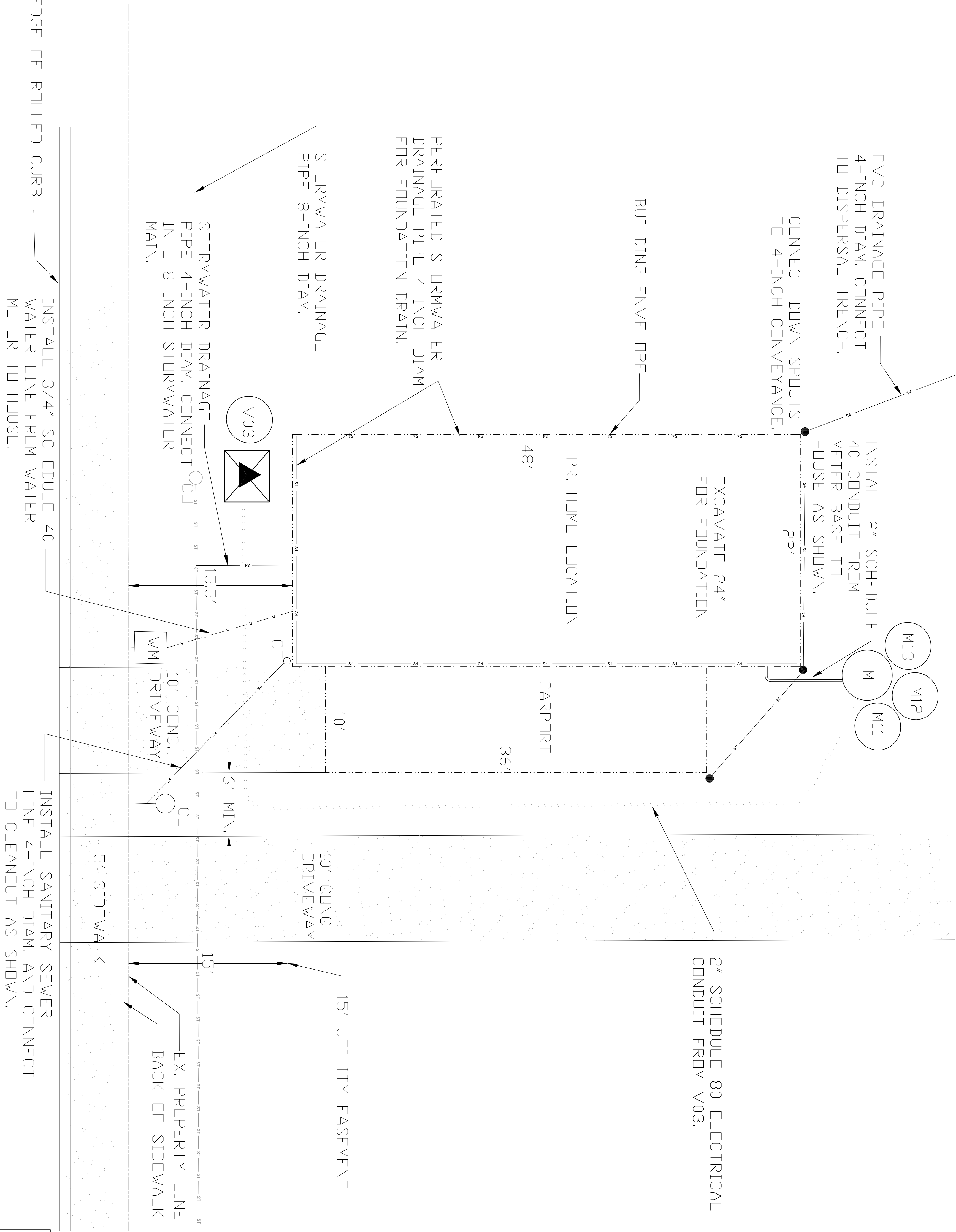

APPROVED FOR CONSTRUCTION

BY: \_\_\_\_\_ SIGNED: City Engineer DATE: \_\_\_\_\_

Approval Expires: \_\_\_\_\_

Sec. 14, TWN. 21N, Range 6E, W.M.  
Rainier View  
Manufactured Home Park  
Building Site

Turner Consulting Engineer  
4405 7th Ave SE Suite 301  
Lacey, WA. 98503  
360-491-6900

REVISION BLOCK:

DESIGN INFORMATION		
PROJECT IDENTIFICATION No.		
FILE NAME: BW-COVER SITE PLAN		
ACTION		
DESIGNED		5-1-24
DRAWN		5-1-24
CHECKED		5-1-24
PLOTTED DATES		

SHEET ID CODE  
BS 12 of 13

SHEET No.  
14 of 15

SEC. 14, TWN. 21N, Range 6E, W.M.

LOT M  
N.T.S.

CONNECT DOWN SPDUTS  
TD 4-INCH CONVEYANCE.

PVC DRAINAGE PIPE  
4-INCH DIAM. CONNECT  
TD DISPERSAL TRENCH.

BUILDING ENVELOPE

EXCAVATE 24"  
FOR FOUNDATION

PVC DRAINAGE PIPE  
4-INCH DIAM. CONNECT  
TD DISPERSAL TRENCH.

PR. HOME LOCATION

INSTALL 2" SCHEDULE  
40 CONDUIT FROM  
METER BASE TD  
HOUSE AS SHOWN.

2" SCHEDULE 80 ELECTRICAL  
CONDUIT FROM V03.

INSTALL SANITARY SEWER  
LINE 4-INCH DIAM. AND CONNECT  
TD CLEANDUT AS SHOWN.

15' UTILITY EASEMENT

10' CONC.  
DRIVEWAY

INSTALL 3/4" SCHEDULE 40  
WATER LINE FROM WATER  
METER TD HOUSE.

5' SIDEWALK

EX. PROPERTY LINE  
BACK OF SIDEWALK

EDGE OF ROLLED CURB

APPROVED FOR CONSTRUCTION

BY: \_\_\_\_\_ DATE: \_\_\_\_\_

Signed, City Engineer

Approval Expires: \_\_\_\_\_

Sec. 14, TWN. 21N, Range 6E, W.M.

Rainier View  
Manufactured Home Park  
Building Site

Turner  
Consulting  
Engineer  
4405 7th Ave SE Suite 301  
Lacey, WA. 98503  
360-491-6900

REVISION BLOCK:

DESIGN INFORMATION

PROJECT IDENTIFICATION No.  
FILE NAME: BW-COVER SITE PLAN

ACTION		
DESIGNED		
DRAWN		
CHECKED		
PLOTTED DATES		

SHEET ID CODE  
BS 13 of 13

SHEET No.  
15 of 15